

APP760 - Palm Sander

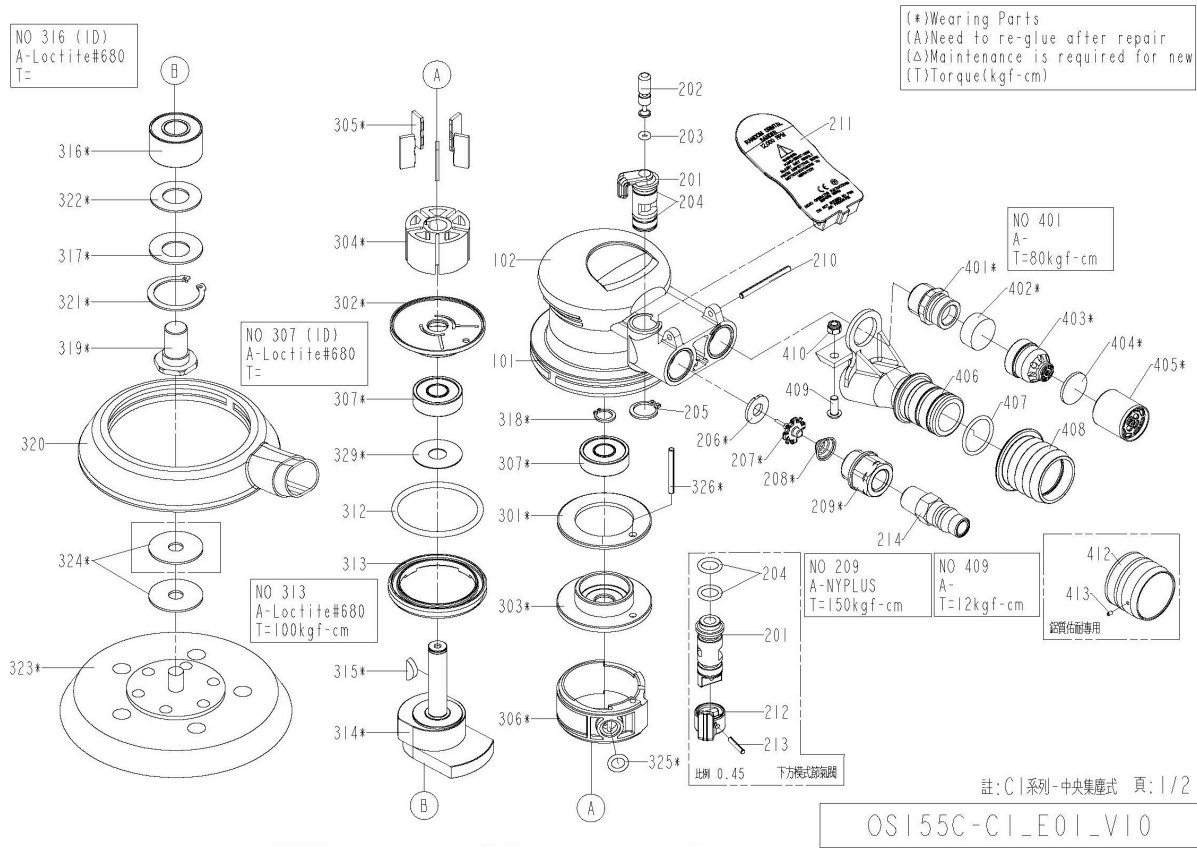

| Ref | PCL Part No | Description | Qty |
|-----|-------------|----------------------|-----|
| 101 | APS760/101 | Housing | 1 |
| 201 | APS760/RLR | Regulator | 1 |
| 202 | APS760/VSM | Valve stem | 1 |
| 203 | APS760/203 | O-ring | 1 |
| 204 | APS760/204 | O-ring | 2 |
| 205 | APS760/205 | S-ring | 1 |
| 206 | APS760/206 | Seal | 1 |
| 207 | APS760/207 | Tip valve | 1 |
| 208 | APS760/208 | Spring | 1 |
| 209 | APS760/209 | Air inlet | 1 |
| 210 | APS760/210 | Spring pin | 1 |
| 211 | APS760/211 | Trigger | 1 |
| 301 | APS760/301 | Front Ring | 1 |
| 302 | APS760/302 | Rear bearing plate | 1 |
| 303 | APS760/303 | Front end plate | 1 |
| 304 | APS760/304 | Rotor | 1 |
| 305 | APS760/RBS | Blades | 5 |
| 306 | APS760/306 | Cylinder | 1 |
| 307 | APS760/307 | Bearing | 1 |
| 312 | APS760/312 | O-ring | 1 |
| 313 | APS760/313 | Lock ring | 1 |
| 314 | APS760/314 | Motor shaft balancer | 1 |
| 315 | APS760/315 | Rotor key | 1 |

| Ref | PCL Part No | Description | Qty |
|-----|-------------|-------------------------------|-----|
| 316 | APS760/316 | Bearing | 1 |
| 317 | APS760/317 | Bearing Shield | 1 |
| 318 | APS760/318 | C-Ring | 1 |
| 319 | APS760/319 | Balancer Shaft | 1 |
| 320 | APS760/320 | Shroud | 1 |
| 321 | APS760/321 | Snap ring | 1 |
| 322 | APS760/322 | Bearing seal | 1 |
| 323 | APS760/323 | 6" pad (6) holes hook (Black) | 1 |
| 324 | APS760/324 | Heat isolation washer | 2 |
| 325 | APS760/325 | O-ring | 1 |
| 326 | APS760/326 | Spring pin | 1 |
| 329 | APS760/329 | Vacuum bridge collar | 1 |
| 401 | APS760/MSW | Muffler screw | 1 |
| 402 | APS760/402 | Muffler | 1 |
| 403 | APS760/NZE | Nozzle | 1 |
| 404 | APS760/404 | Muffler | 1 |
| 405 | APS760/MCP | Muffler cap | 1 |
| 406 | APS760/406 | Vacuum adaptor-central vac | 1 |
| 407 | APS760/407 | O-ring | 1 |
| 408 | APS760/408 | Revolving connector | 1 |
| 409 | APS760/409 | Half round HD hex bolt | 1 |
| 410 | APS760/410 | U-nut | 1 |